

Electrak® 10

12, 24 and 36 Vdc - load up to 6800 N

Ordering Key

1	2	3	4	5
D12 -	20B5 -	04	M0	N

1. Input voltage

D12 - = 12 Vdc
D24 - = 24 Vdc
D36 - = 36 Vdc

2. Dynamic load capacity, screw type and maximum speed

05A5 - = 1100 N, acme, 54 mm/s
10A5 - = 2250 N, acme, 30 mm/s
20A5 - = 2250 N, acme, 15 mm/s
05B5 - = 2250 N, ball, 61 mm/s
10B5 - = 4500 N, ball, 30 mm/s
20B5 - = 4500 N, ball, 15 mm/s
21B5 - = 6800 N, ball, 15 mm/s

3. Stroke

04 = 4 inch (101,6 mm)
06 = 6 inch (152,4 mm)
08 = 8 inch (203,2 mm)
10 = 10 inch (254,0 mm)
12 = 12 inch (304,8 mm)
14 = 14 inch (355,6 mm)
16 = 16 inch (406,4 mm)
18 = 18 inch (457,2 mm)
20 = 20 inch (508,0 mm)
24 = 24 inch (609,6 mm)

4. Rear adapter hole position¹

M0 = adaptor at 0° (standard position)
M1 = adaptor at 30°
M2 = adaptor at 60°
M3 = adaptor at 90°
M4 = adaptor at 120°
M5 = adaptor at 150°

5. Options

N = no option
NPO = potentiometer
NHW = manual override²

¹ Definition of rear adapter hole positions.

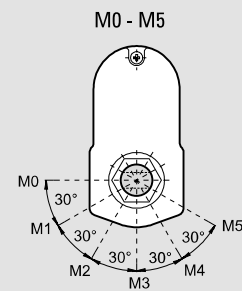

² Dimensions for manual override option.

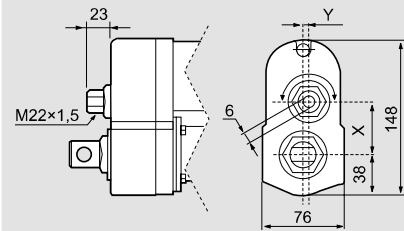

Model	X	Y
05A(B)5 -	49,6	0,0
10A(B)5 -	43,3	5,2
20(21)A(B)5 -	38,9	0,0

Electrak® 10

12, 24 and 36 Vdc - load up to 6800 N

Wiring Diagram

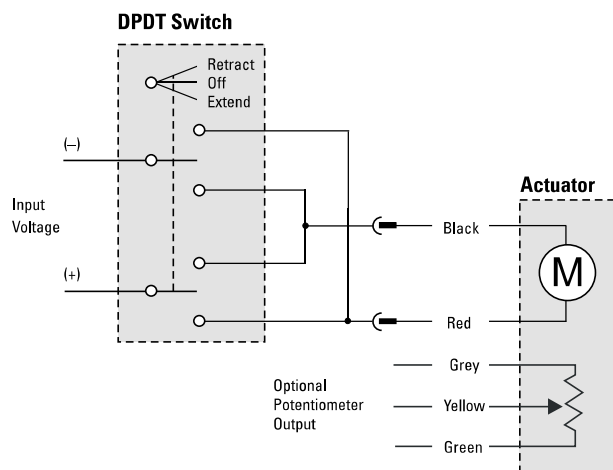

Connect the red lead to positive and black to negative to extend the actuator. Change polarity to retract the actuator. The potentiometer output has 0 ohm between grey and yellow when the actuator is fully extended.

Electrak® LA14

12, 24 and 36 Vdc - load up to 6800 N



Standard Features and Benefits

- Rugged and robust
- Withstands very harsh environments
- Stainless steel extension tube
- Corrosion free aluminium cover tube
- Acme or ball screw drive
- Trunnion mounting possible
- Overload clutch for mid and end of stroke protection
- T-slot grooves in the cover tube for magnetic sensors
- Motor with thermal switch
- Maintenance free

General Specifications

Parameter	Electrak LA14
Screw type	acme or ball
Internally restrained	yes
Manual override	no, optional
Dynamic braking	no
Holding brake	
acme screw models	no, self-locking
ball screw models	yes
End of stroke protection	overload clutch
Mid stroke protection	overload clutch
Motor protection	auto reset thermal switch
Motor connection	flying leads and connector
Motor connector	AMP connector with housing p/n 180908-5 with male terminals p/n 42098-2
Certificates	CE
Options	<ul style="list-style-type: none"> • potentiometer • manual override

Performance Specifications

Parameter		Electrak LA14
Maximum load, dynamic / static	[N]	
DA •• -05A65M (acme screw)		1100 / 11350
DA •• -10A65M (acme screw)		2250 / 11350
DA •• -20A65M (acme screw)		2250 / 11350
DA •• -05B65M (ball screw)		2250 / 18000
DA •• -10B65M (ball screw)		4500 / 18000
DA •• -20B65M (ball screw)		4500 / 18000
DA •• -21B65M (ball screw)		6800 / 18000
Speed, at no load / at maximum load	[mm/s]	
DA •• -05A65M (acme screw)		54 / 32
DA •• -10A65M (acme screw)		30 / 18
DA •• -20A65M (acme screw)		15 / 12
DA •• -05B65M (ball screw)		61 / 37
DA •• -10B65M (ball screw)		30 / 19
DA •• -20B65M (ball screw)		15 / 12
DA •• -21B65M (ball screw)		15 / 11
Available input voltages	[Vdc]	12, 24, 36 *
Standard stroke lengths	[mm]	50, 100, 150, 200, 250, 300, 350, 400, 450, 500, 550, 600
Operating temperature limits	[°C]	-25 – +65
Full load duty cycle @ 25 °C	[%]	25
End play, maximum	[mm]	1,0
Restraining torque	[Nm]	0
Lead cross section	[mm ²]	2
Lead length	[mm]	165
Protection class		IP65

* Other input voltages available on request, contact customer support.

Electrak® LA14

12, 24 and 36 Vdc - load up to 6800 N

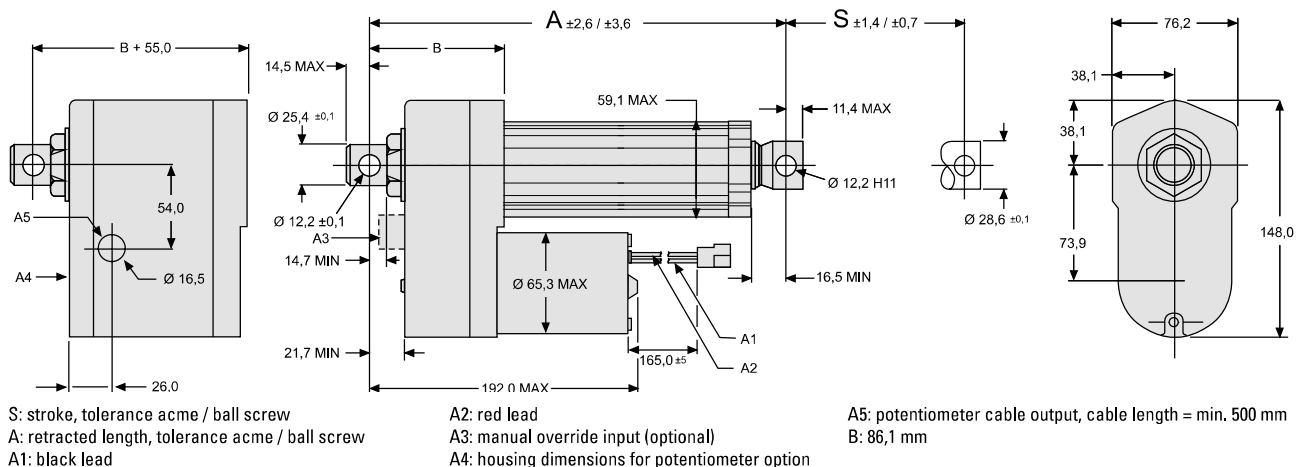

Stroke (S)	[mm]	50	100	150	200	250	300	350	400	450	500	550	600
Retracted length, acme screw models (A)	[mm]	216,7	266,7	316,7	366,7	416,7	466,7	566,7	616,7	666,7	716,7	766,7	816,7
Retracted length, ball screw models (A)	[mm]	269,6	319,6	369,6	419,6	469,6	519,6	619,6	669,6	719,6	769,6	819,6	869,6
Add on length for potentiometer*	[mm]	55,0	55,0	55,0	55,0	55,0	55,0	55,0	55,0	55,0	55,0	55,0	55,0
Weight, acme screw models	[kg]	4,5	4,7	4,9	5,1	5,3	5,5	5,8	6,0	6,2	6,4	6,6	6,8
Weight, ball screw models	[kg]	5,3	5,5	5,7	5,9	6,1	6,3	6,6	6,8	7,0	7,2	7,4	7,6
Add on weight for potentiometer*	[kg]	1,3	1,3	1,3	1,3	1,3	1,3	1,3	1,3	1,3	1,3	1,3	1,3
Potentiometer resistance change*	[ohm/mm]	39	39	39	39	39	20	20	20	20	20	10	10

* Potentiometer is optional

Performance Diagrams

Acme Screw Models
Speed and Current vs. Load

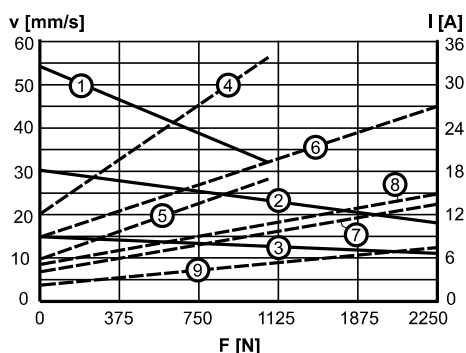

- V: speed
- I: current
- F: load
- 1: speed DA ••-05A65M
- 2: speed DA ••-10A65M
- 3: speed DA ••-20A65M
- 4: current 12 Vdc, DA12-05A65M
- 5: current 24 Vdc, DA24-05A65M
- 6: current 12 Vdc, DA12-10A65M
- 7: current 24 Vdc, DA24-10A65M
- 8: current 12 Vdc, DA12-20A65M
- 9: current 24 Vdc, DA24-20A65M

Ball Screw Models
Speed and Current vs. Load

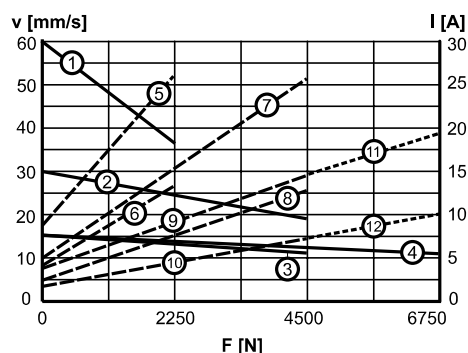

- V: speed
- I: current
- F: load
- 1: speed DA ••-05B65M
- 2: speed DA ••-10B65M
- 3: speed DA ••-20B65M
- 4: speed DA ••-21B65M
- 5: current 12 Vdc, DA12-05B65M
- 6: current 24 Vdc, DA24-05B65M
- 7: current 12 Vdc, DA12-10B65M
- 8: current 24 Vdc, DA24-10B65M
- 9: current 12 Vdc, DA12-20B65M
- 10: current 24 Vdc, DA24-20B65M
- 11: current 12 Vdc, DA12-21B65M
- 12: current 24 Vdc, DA24-21B65M